

1 NO COLUMNS REQD AS DRAWN & MKD 1/NC9.

VIEW ON BB. ENLARGED EXISTING CAP PLT DETAIL.

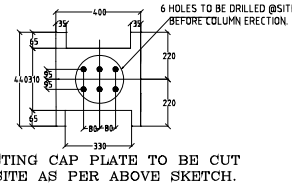

EXISTING CAP PLATE TO BE CUT @ SITE AS PER ABOVE SKETCH.

BILL OF MATERIAL - COLUMN NC9.

ITEMNO	NAME	SECTION & LENGTH	NOS	TOTAL METRE/UR	W PER METRE	WT IN KG	NOS REQD	TOTAL WT IN KG
NC9	COLUMN	2MB400X140X7300LG	1	14.6	61.5	900	1	900
CH1	CHANNEL	MC300X90X1410LG	1	14.1	36.3	52	2	104
CH2	CHANNEL	MC300X90X1020LG	1	1.020	36.3	38	2	76
CH3	CHANNEL	MC300X90X1020LG	1	1.020	36.3	38	2	76
CH4	CHANNEL	MC300X90X3000LG	2	6	36.3	218	2	436
LA1	LACING ANG	2/75X75XBLX1760LG	1	3.52	8.9	32	2	64
LA2	LACING ANG	2/75X75XBLX1760LG	1	3.52	8.9	32	2	64
BT1	BATTEN PLT	420X10X930LG	1	3.52	78.5	30	2	60
BT2	BATTEN PLT	420X10X300LG	1	0.126	78.5	10	2	20
BT3	BATTEN PLT	420X10X300LG	1	0.126	78.5	10	2	20
BT4	BATTEN PLT	420X10X1000LG	1	0.46	78.5	34	2	68
BT5	BATTEN PLT	420X10X350LG	1	0.147	78.5	12	2	24
BT7	BATTEN PLT	420X10X300LG	1	0.126	78.5	10	2	20
BT8	BATTEN PLT	380X10X300LG	1	0.114	78.5	9	2	18
BT9	BATTEN PLT	300X10X380LG	1	0.114	78.5	9	2	18
BT10	BATTEN PLT	380X10X650LG	1	0.247	78.5	20	2	40
BT11	BATTEN PLT	420X10X300LG	1	0.126	78.5	10	2	20
BT12	BATTEN PLT	420X10X240LG	1	0.1008	78.5	9	2	18
BT13	BATTEN PLT	420X10X550LG	1	0.231	78.5	18	2	36
RB1	RIB PLATE	300X10X384LG	1	1.152	78.5	10	4	40
RB2	RIB PLATE	82X10X284LG	1	0.232	78.5	2	12	24
RB3	RIB PLATE	170X10X300LG	1	0.051	78.5	4	2	8
RB4	RIB PLATE	215X10X300LG	1	0.045	78.5	6	4	24
PKP	PACKING PLT	280X20X3000LG	1	84	157	132	4	528
P1	END PLATE	300X10X600LG	1	1.8	78.5	15	2	30
P2	END PLATE	180X10X380LG	1	1.102	78.5	9	2	18
P3	END PLT	240X10X380LG	1	0.912	78.5	8	2	16
CGP	C GIRDER PLT	245X10X290LG	1	288	157	4.6	2	92
BK1	BRACKET	MB300X140X230LG	1	23	4.6	11	2	22
BK2	BRACKET	MB500X180X530LG	1	0.53	86.9	48	2	96
EP1	END PLATE	530X10X420LG	1	2.26	78.5	18	2	36
EP2	END PLATE	420X20X274LG	1	1.1508	157	18	2	36
EC	END CLT	2/90X90X8X250LG	1	5	10.8	6	2	12
WBC1	WEB CLT C/F	2MC300X90X300LG	1	6	36.3	22	2	44
WBC2	WEB CLT C/F	2MC300X90X200LG	1	6	36.3	22	1	44
R1	RIB PLT	82X10X267LG	2	0.0437	78.5	4	1	4
R2	RIB PLT	82X10X205LG	4	0.6724	78.5	6	1	6
BP	BASE PLT	400X16X440LG	1	1.176	125.6	23	1	23
WP1	WEB RIB PLT	250X16X200LG	1	0.5	125.6	7	2	14
WP2	WEB RIB PLT	250X16X200LG	1	0.5	125.6	7	2	14
FC	FLANGE CLT C/F	2MC300X90X380LG	1	38	36.3	14	2	28
CW	CLT PLT	275X16X380LG	1	104.5	125.6	14	2	28

NOTE: BASE PLT & XG CONNECTION DETAIL TO BE CHECKED BEFORE FABRICATION.
 ALL SEATING SURFACES ARE TO BE GRIND TO FINISH.

REV NO	DATE	REVISION PARTICULARS	CHECKED BY
--------	------	----------------------	------------

CLIENT :
M/S MADRAS FERTILISERS LIMITED
 MANALI, CHENNAI

PROJECT :
REACTOR TUBE BUNDLE PULLING
 SYSTEM

TITLE :
DETAIL OF COLUMNS: NC9

DRAWN: PP	DATE: 26-03-2001
-----------	------------------

SCALE:
STRUCTURAL COMBINES PRIVATE LTD
 STRUCTURAL, BOILER ENGINEERS AND REACTION CONTRACTORS
 203, 11 FLOOR, 187, ELDAMS ROAD, ALWAPET
 CHENNAI 600018

ARCHITECTS & ENGINEERS:-
M/S C.R.NARAYANA RAO.,
 architects & engineers,
 luz, chennai-4

SYSTEM FILE NAME: NODE 1
 DRGNO: 10A